

ARP	49°09'58"N 016°07'28"E	AD ELEV 1547 ft/471,5 m	APPROACH 118,155 266,200 reserve	PRECISION 283,900 123,300 reserve	TOWER 126,505 119,830 reserve	GROUND - -	<b>AERODROME CHART - ICAO NÁMEŠŤ</b>
-----	---------------------------	----------------------------	-------------------------------------	--------------------------------------	----------------------------------	---------------	--------------------------------------

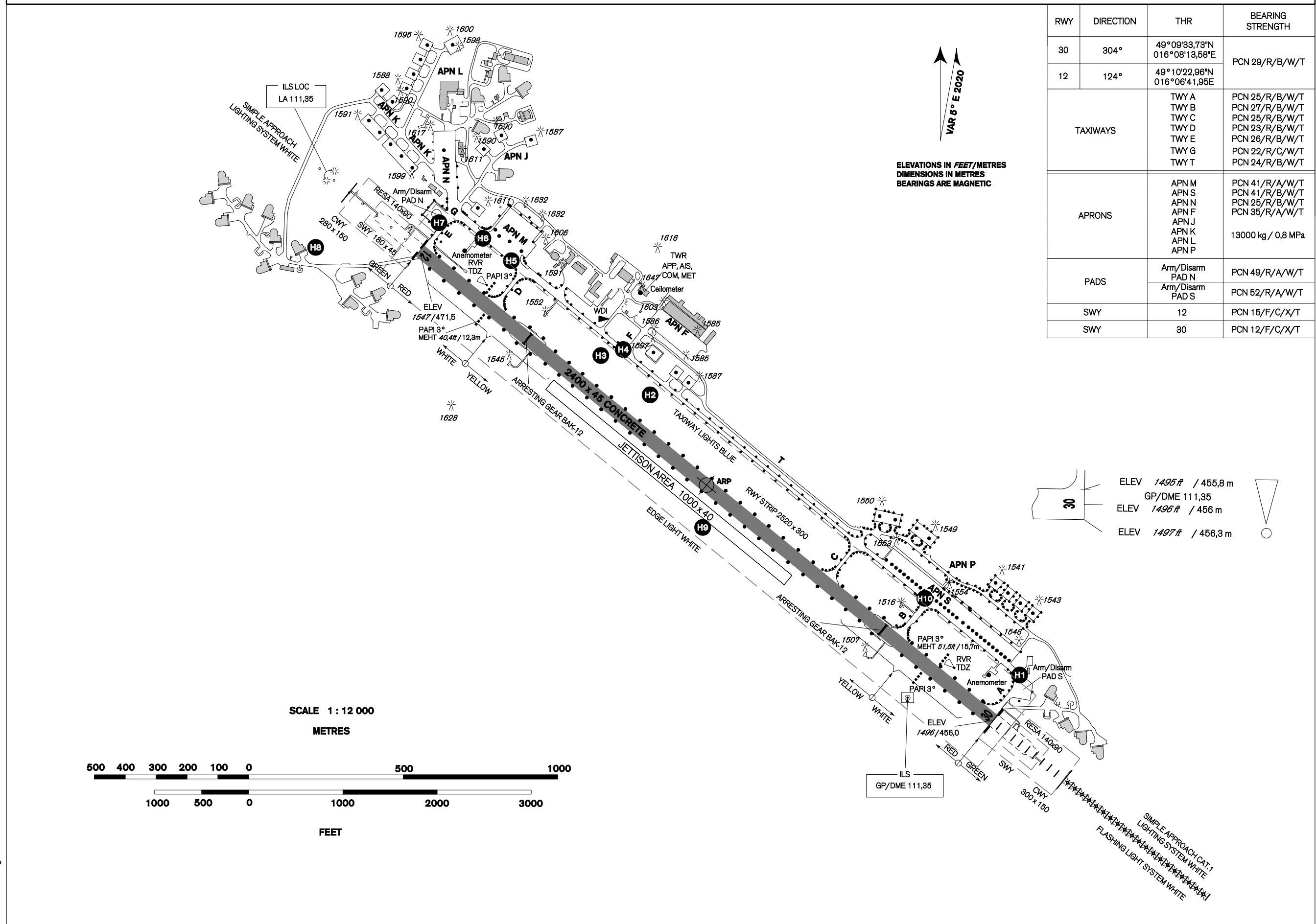

RWY	DIRECTION	THR	BEARING STRENGTH
30	304°	49°09'33,73"N 016°08'13,58"E	PCN 29/R/B/W/T
12	124°	49°10'22,96"N 016°06'41,95"E	
TAXIWAYS		TWY A TWY B TWY C TWY D TWY E TWY G TWY T	PCN 25/R/B/W/T PCN 27/R/B/W/T PCN 25/R/B/W/T PCN 23/R/B/W/T PCN 26/R/B/W/T PCN 22/R/C/W/T PCN 24/R/B/W/T
APRONS		APN M APN S APN N APN F APN J APN K APN L APN P	PCN 41/R/A/W/T PCN 41/R/B/W/T PCN 25/R/B/W/T PCN 35/R/A/W/T 13000 kg / 0,8 MPa
PADS		Arm/Disarm PAD N Arm/Disarm PAD S	PCN 49/R/A/W/T PCN 52/R/A/W/T
SWY		12	PCN 15/F/C/X/T
SWY		30	PCN 12/F/C/X/T

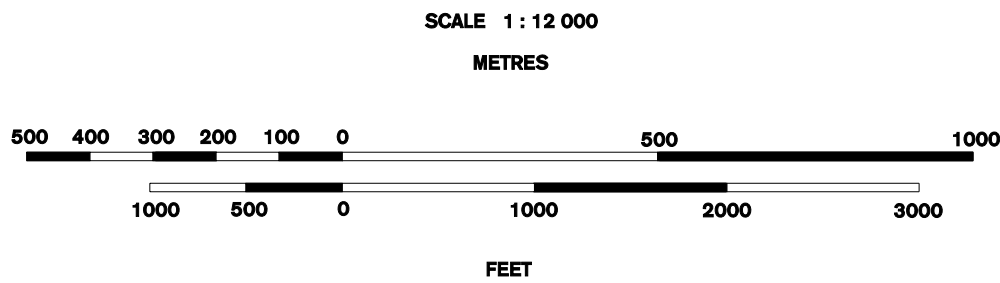

	ELEV 1495 ft / 455,8 m GP/DME 111,35
	ELEV 1496 ft / 456 m
	ELEV 1497 ft / 456,3 m

change: chart revision - obstacles

# AERODROME CHART - ICAO - MARKINGS ON MANOEUVRING AREA

NÁMĚŠŤ

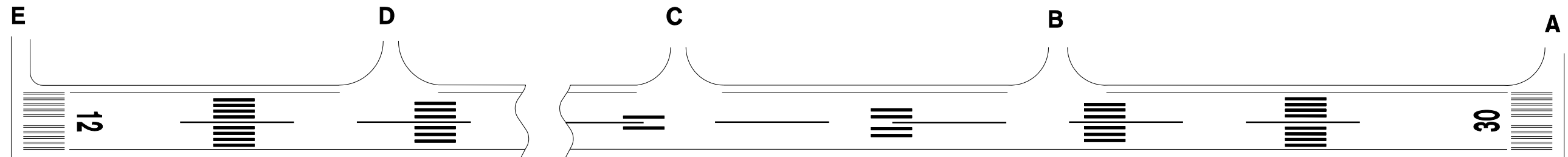

change: RWY designation