

DELIVERY GROUND TWR	120,060 121,910 134,560	S1 - S9 APRON ELEV 1197 ft / 365 m	S14 - S17 APRON ELEV 1191 ft / 363 m	S51 - S56 APRON ELEV 1201 ft / 366 m
---------------------	-------------------------------	---------------------------------------	---	---

PARKING STANDS AND TAXIING ON APRON SOUTH

PRAHA/Ruzyně

STANDS	WING SPAN (m)	INS COORDINATES		NOTICE	
S1	21,3	50°05'51,52''N	014°17'10,38''E	50°05,9'N 014°17,2'E	
S2	24	50°05'51,36''N	014°17'09,12''E	50°05,9'N 014°17,2'E	
S3	21,3	50°05'51,20''N	014°17'07,84''E	50°05,9'N 014°17,1'E	
S4	21,3	50°05'51,05''N	014°17'06,64''E	50°05,9'N 014°17,1'E	
S5	29	50°05'54,07''N	014°17'09,30''E	50°05,9'N 014°17,2'E	
S5A	36	50°05'54,02''N	014°17'08,97''E	50°05,9'N 014°17,1'E	alternative stand
S6	29	50°05'53,85''N	014°17'07,65''E	50°05,9'N 014°17,1'E	
S6A	65	50°05'53,10''N	014°17'07,66''E	50°05,9'N 014°17,1'E	alternative stand
S7	21,3	50°05'53,67''N	014°17'06,18''E	50°05,9'N 014°17,1'E	
S7A	36	50°05'53,74''N	014°17'06,74''E	50°05,9'N 014°17,1'E	alternative stand
S9	29	50°05'56,96''N	014°17'07,89''E	50°05,9'N 014°17,1'E	
S10	15	50°05'48,83''N	014°17'10,76''E	50°05,8'N 014°17,2'E	stand available SR-SS
S14	24	50°05'52,50''N	014°16'43,70''E	50°05,9'N 014°16,7'E	stand available SR-SS
S15	24	50°05'54,26''N	014°16'45,60''E	50°05,9'N 014°16,8'E	stand available SR-SS
S16	24	50°05'55,81''N	014°16'47,41''E	50°05,9'N 014°16,8'E	stand available SR-SS
S17	24	50°05'57,34''N	014°16'49,28''E	50°06,0'N 014°16,8'E	stand available SR-SS
S30	20	50°05'48,74''N	014°17'10,93''E	50°05,8'N 014°17,2'E	alternative stand stand available SR-SS
S51	11	50°05'48,84''N	014°17'00,63''E	50°05,8'N 014°17,0'E	stand available SR-SS
S52	15	50°05'46,73''N	014°17'00,42''E	50°05,8'N 014°17,0'E	stand available SR-SS
S53	15	50°05'47,15''N	014°16'59,72''E	50°05,8'N 014°17,0'E	stand available SR-SS
S54	20	50°05'47,37''N	014°16'58,78''E	50°05,8'N 014°17,0'E	stand available SR-SS
S55	20	50°05'46,99''N	014°16'56,97''E	50°05,8'N 014°16,9'E	stand available SR-SS
S56	20	50°05'46,56''N	014°16'55,15''E	50°05,8'N 014°16,9'E	stand available SR-SS

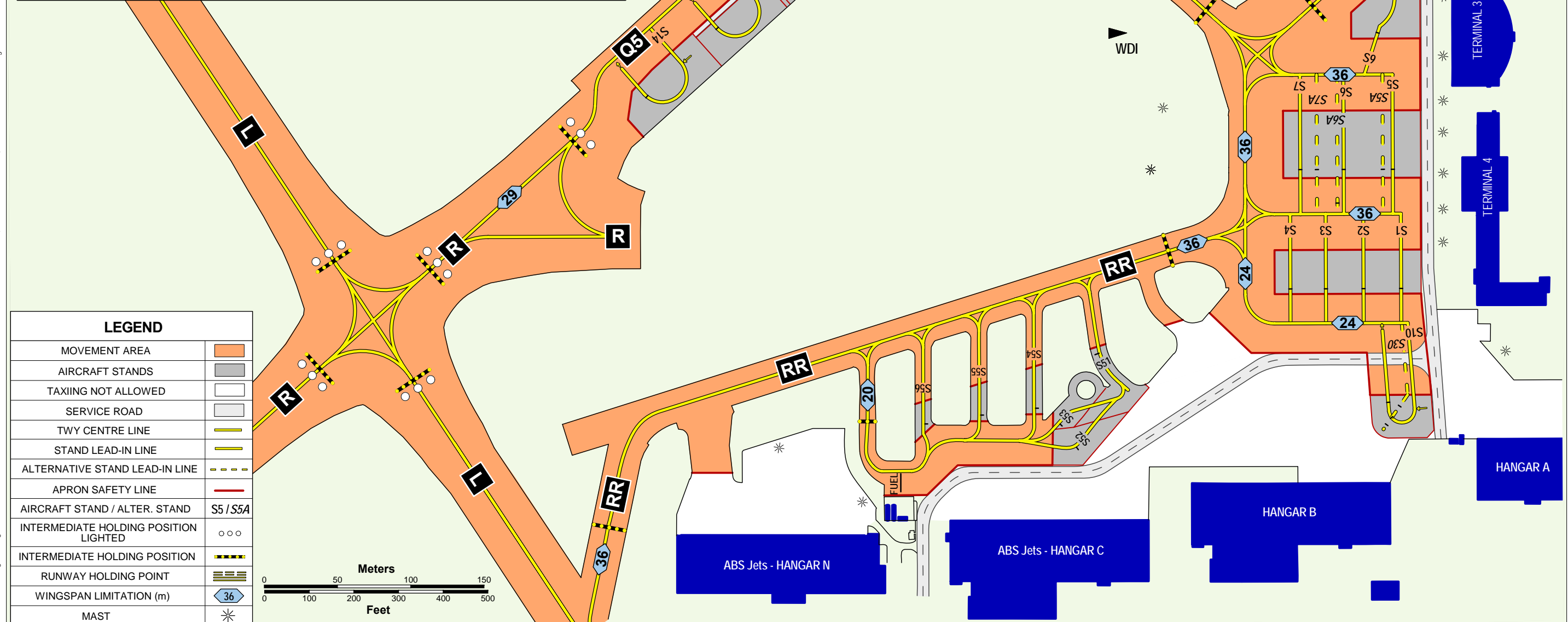

change: existing TWY R remained to TWY RR; new TWY R and intersection TWY L x TWY R; stand S11, S13 withdrawn; coordinates of stand S14; MAG VAR - annual rate of change from 8' to 10'