

|   |                               |  |  |   |                      |                                     |
|---|-------------------------------|--|--|---|----------------------|-------------------------------------|
| <b>ARP</b><br>50°07'17"N<br>014°32'37"E | <b>ELEV</b><br>939 ft / 286 m | <b>APPROACH</b> 124,680<br>291,050 reserve | <b>PRECISION</b> 126,760<br>123,300 reserve<br>315,000 reserve | <b>TOWER</b> 120,880<br>134,730 reserve | <b>GROUND</b> -<br>- | <b>AERODROME CHART - ICAO KBELY</b> |
| <b>RWY</b>                              | <b>DIRECTION</b>              | <b>THR</b>                                 | <b>BEARING STRENGTH</b>  |   |                      |                                     |

|          |  |  |                |
|----------|--|--|----------------|
| 24       | 238°   | 50°07'31,93"N<br>014°33'21,70"E  | PCN 48/F/B/W/T |
| 06       | 058°   | 50°07'01,90"N<br>014°31'52,51"E  |                |
| TAXIWAYS | TWY A<br>TWY B<br>TWY C<br>TWY D<br>TWY E<br>TWY F<br>TWY G<br>TWY J | PCN 60/R/A/W/T<br>PCN 60/R/A/W/T<br>PCN 60/R/A/W/T<br>PCN 44/F/B/W/T<br>PCN 37/F/C/W/T<br>PCN 44/F/B/W/T<br>PCN 29/F/C/W/T<br>PCN 27/R/C/W/T |                |
| APRON    | EAST<br>MIDDLE<br>WEST<br>SOUTH                                      | PCN 21/R/C/W/T<br>PCN 25/R/C/W/T<br>PCN 44/F/B/W/T<br>PCN 21/R/B/W/T   |                |

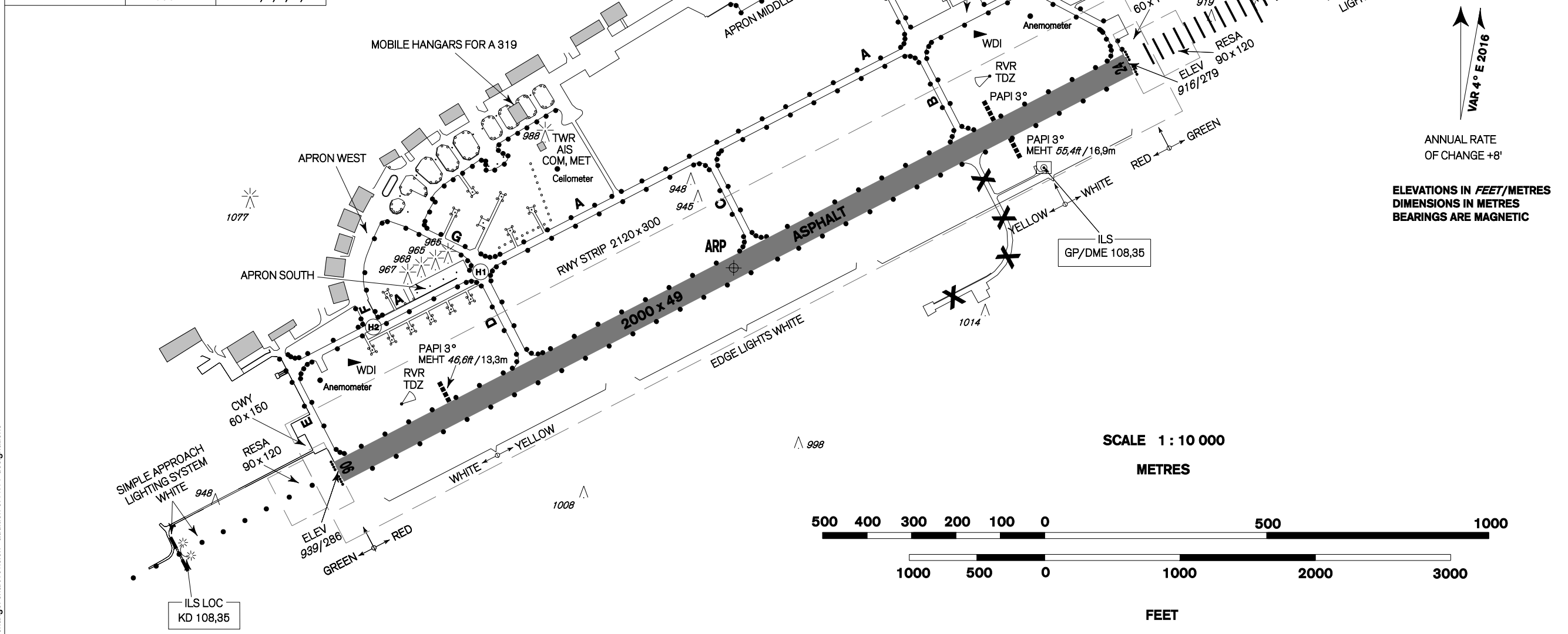

change: chart revision - addition of RWY designations

**MARKINGS ON MANOEUVRING AREA**

