

ARP 50°07'17"N 014°32'37"E	ELEV 939 ft / 286 m	APPROACH 124,680 291,050 reserve	PRECISION 126,760 123,300 reserve 315,000 reserve	TOWER 120,880 134,730 reserve	GROUND - -	AERODROME CHART - ICAO KBELY
RWY	DIRECTION	THR	BEARING STRENGTH			

24	238°	50°07'31,93"N 014°33'21,70"E	PCN 48/F/B/W/T
06	058°	50°07'01,90"N 014°31'52,51"E	
TAXIWAYS	TWY A	PCN 60/R/A/W/T	
	TWY B	PCN 60/R/A/W/T	
	TWY C	PCN 60/R/A/W/T	
	TWY D	PCN 44/F/B/W/T	
	TWY E	PCN 37/F/C/W/T	
	TWY F	PCN 44/F/B/W/T	
APRON	EAST	PCN 21/R/C/W/T	
	MIDDLE	PCN 25/R/C/W/T	
	WEST	PCN 44/F/B/W/T	
PADS	PAD E	PCN 16/R/B/W/T	
	PAD A	PCN 17/R/C/W/T	

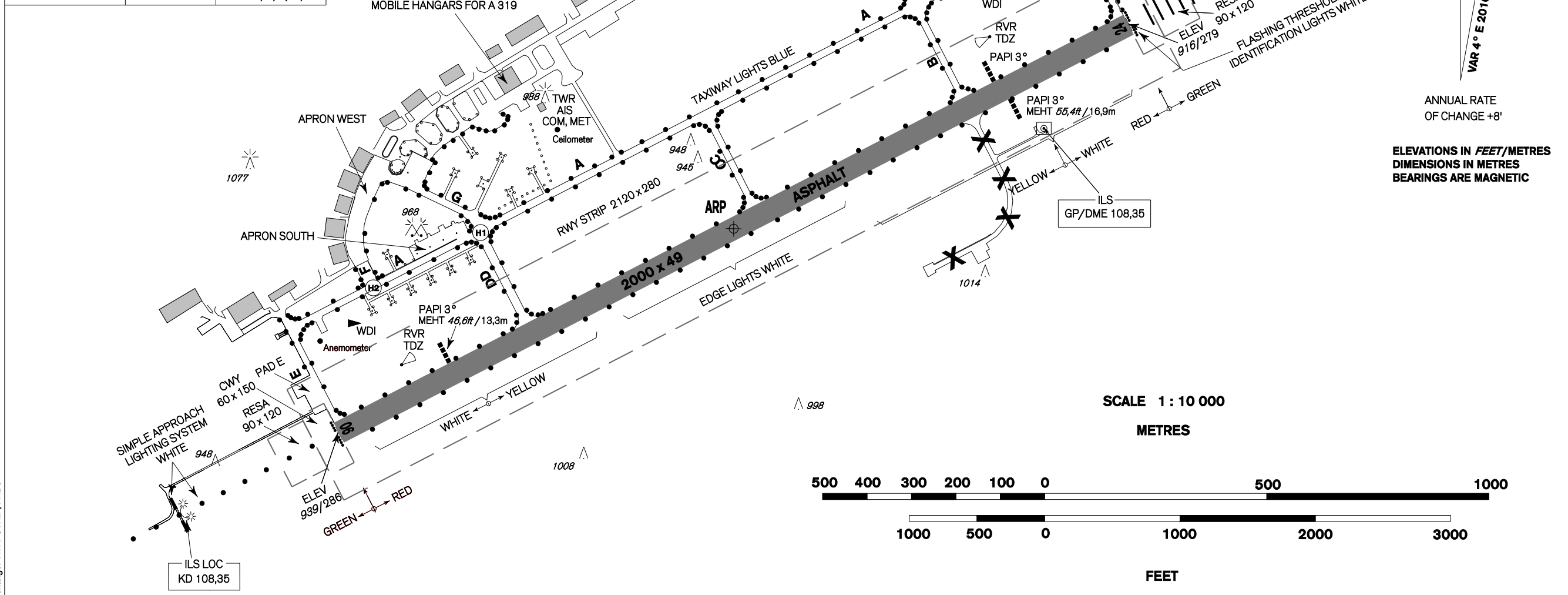

change: RWY STRIP, PADS

MARKINGS ON MANOEUVRING AREA

