

| | | | | |
|---------------------|-------------------------------|---------------------------------------|-----------------------------------------|-----------------------------------------|
| DELIVERY GROUND TWR | 120,060 121,910 134,560 | S1 - S9 APRON ELEV 1197 ft / 365 m | S14 - S17 APRON ELEV 1191 ft / 363 m | S19 - S26 APRON ELEV 1201 ft / 366 m |
|---------------------|-------------------------------|---------------------------------------|-----------------------------------------|-----------------------------------------|

PARKING STANDS AND TAXIING ON APRON SOUTH

PRAHA/Ruzyně

| STANDS | WING SPAN (m) | INS COORDINATES | | NOTICE | |
|--------|---------------|-----------------|----------------|----------------------|-----------------------|
| S1 | 21,3 | 50°05'51,52"N | 014°17'10,38"E | 50°05,9'N 014°17,2'E | |
| S2 | 24 | 50°05'51,36"N | 014°17'09,12"E | 50°05,9'N 014°17,2'E | |
| S3 | 21,3 | 50°05'51,20"N | 014°17'07,84"E | 50°05,9'N 014°17,1'E | |
| S4 | 21,3 | 50°05'51,05"N | 014°17'06,64"E | 50°05,9'N 014°17,1'E | |
| S5 | 29 | 50°05'54,07"N | 014°17'09,30"E | 50°05,9'N 014°17,2'E | |
| S5A | 36 | 50°05'54,02"N | 014°17'08,97"E | 50°05,9'N 014°17,1'E | alternative stand |
| S6 | 29 | 50°05'53,85"N | 014°17'07,65"E | 50°05,9'N 014°17,1'E | |
| S6A | 65 + 74H | 50°05'53,10"N | 014°17'07,66"E | 50°05,9'N 014°17,1'E | alternative stand |
| S7 | 21,3 | 50°05'53,67"N | 014°17'06,18"E | 50°05,9'N 014°17,1'E | |
| S7A | 36 | 50°05'53,74"N | 014°17'06,74"E | 50°05,9'N 014°17,1'E | alternative stand |
| S9 | 29 | 50°05'56,96"N | 014°17'07,89"E | 50°05,9'N 014°17,1'E | |
| S14 | 24 | 50°05'52,50"N | 014°16'43,70"E | 50°05,9'N 014°16,7'E | stand available SR-SS |
| S15 | 24 | 50°05'54,26"N | 014°16'45,60"E | 50°05,9'N 014°16,8'E | stand available SR-SS |
| S16 | 24 | 50°05'55,81"N | 014°16'47,41"E | 50°05,9'N 014°16,8'E | stand available SR-SS |
| S17 | 24 | 50°05'57,34"N | 014°16'49,28"E | 50°06,0'N 014°16,8'E | stand available SR-SS |
| S19 | 15 | 50°05'45,27"N | 014°16'54,62"E | 50°05,8'N 014°16,9'E | stand available SR-SS |
| S20 | 29 | 50°05'49,05"N | 014°17'03,11"E | 50°05,8'N 014°17,1'E | |
| S20A | 36 | 50°05'48,88"N | 014°17'02,75"E | 50°05,8'N 014°17,0'E | alternative stand |
| S21 | 29 | 50°05'48,80"N | 014°17'01,18"E | 50°05,8'N 014°17,0'E | |
| S22 | 29 | 50°05'48,56"N | 014°16'59,26"E | 50°05,8'N 014°17,0'E | |
| S22A | 36 | 50°05'48,49"N | 014°16'59,69"E | 50°05,8'N 014°17,0'E | alternative stand |
| S23 | 29 | 50°05'48,31"N | 014°16'57,31"E | 50°05,8'N 014°17,0'E | |
| S23A | 36 | 50°05'48,14"N | 014°16'56,99"E | 50°05,8'N 014°16,9'E | alternative stand |
| S24 | 29 | 50°05'48,06"N | 014°16'55,38"E | 50°05,8'N 014°16,9'E | |
| S25 | 29 | 50°05'47,82"N | 014°16'53,46"E | 50°05,8'N 014°16,9'E | |
| S25A | 36 + LOH | 50°05'47,87"N | 014°16'54,16"E | 50°05,8'N 014°16,9'E | alternative stand |
| S26 | 65 + 74H | 50°05'46,69"N | 014°16'50,67"E | 50°05,8'N 014°16,8'E | |
| S26A | 29 | 50°05'47,57"N | 014°16'51,53"E | 50°05,8'N 014°16,9'E | alternative stand |
| S26B | 31 | 50°05'47,17"N | 014°16'49,60"E | 50°05,8'N 014°16,8'E | alternative stand |
| S30 | 13 | 50°05'48,72"N | 014°17'09,69"E | 50°05,8'N 014°17,2'E | stand available SR-SS |

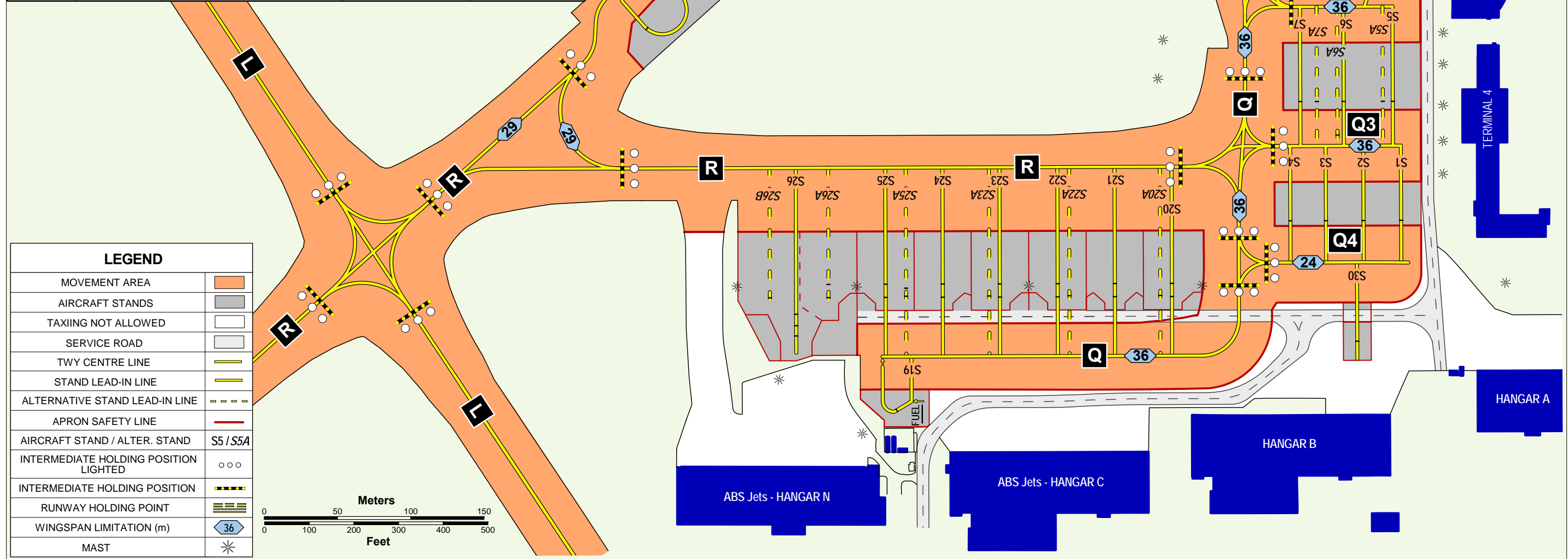

| LEGEND | |
|---------------------------------------|----------|
| MOVEMENT AREA | |
| AIRCRAFT STANDS | |
| TAXIING NOT ALLOWED | |
| SERVICE ROAD | |
| TWY CENTRE LINE | |
| STAND LEAD-IN LINE | |
| ALTERNATIVE STAND LEAD-IN LINE | |
| APRON SAFETY LINE | |
| AIRCRAFT STAND / ALTER. STAND | S5 / S5A |
| INTERMEDIATE HOLDING POSITION LIGHTED | |
| INTERMEDIATE HOLDING POSITION | |
| RUNWAY HOLDING POINT | |
| WINGSPAN LIMITATION (m) | |
| MAST | |

change: VAR - from 4°E 2020 to 5°E 2022