

RWY	DIRECTION	THR	BEARING STRENGTH
06	060°	50°06'06,61"N 014°13'34,68"E	PCN 75/R/B/W/T exceeding is allowed by airport operator
24	240°	50°06'57,42"N 014°16'24,12"E	
12	122°	50°06'28,84"N 014°14'43,32"E	PCN 62/R/B/X/T exceeding is allowed by airport operator
30	302°	50°05'25,68"N 014°16'54,02"E	
TAXIWAYS		TWY L, L1 TWY P, Q other TWYs	PCN 50/F/D/X/T PCN 40/F/D/X/T PCN 60/R/B/X/T

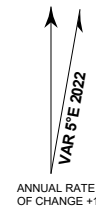

GUND (Geoid Undulation) IN ft / m
ELEVATIONS IN ft / m
DIMENSIONS IN m
BEARINGS ARE MAGNETIC

Circumnavigation of other aircraft within the holding areas is the responsibility of the Pilot-In-Command as wing tip clearance is not assured

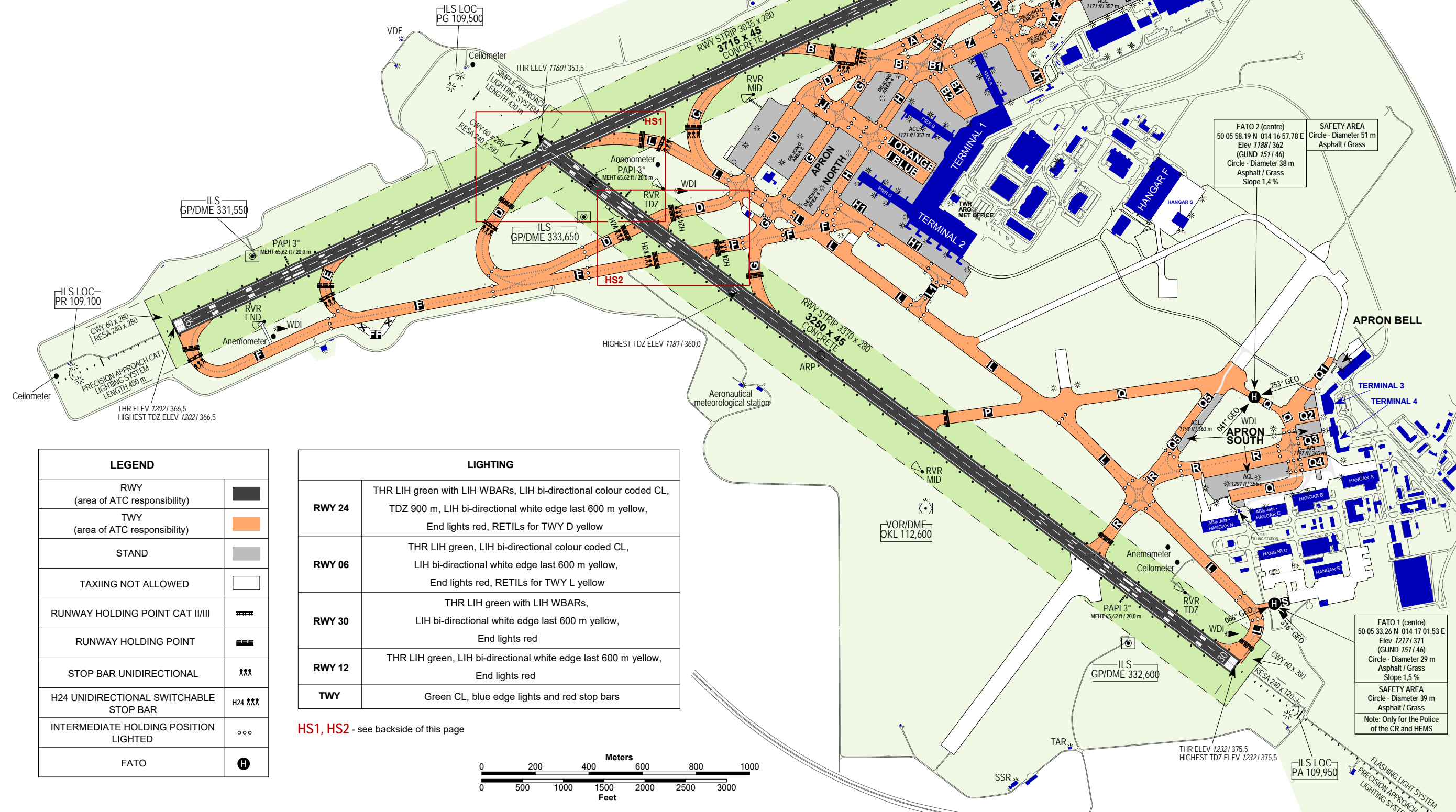

LEGEND	
RWY (area of ATC responsibility)	
TWY (area of ATC responsibility)	
STAND	
TAXIING NOT ALLOWED	
RUNWAY HOLDING POINT CAT II/III	
RUNWAY HOLDING POINT	
STOP BAR UNIDIRECTIONAL	
H24 UNIDIRECTIONAL SWITCHABLE STOP BAR	
INTERMEDIATE HOLDING POSITION LIGHTED	
FATO	

LIGHTING	
RWY 24	THR LIH green with LIH WBARs, LIH bi-directional colour coded CL, TDZ 900 m, LIH bi-directional white edge last 600 m yellow, End lights red, RETILs for TWY D yellow
RWY 06	THR LIH green, LIH bi-directional colour coded CL, LIH bi-directional white edge last 600 m yellow, End lights red, RETILs for TWY L yellow
RWY 30	THR LIH green with LIH WBARs, LIH bi-directional white edge last 600 m yellow, End lights red
RWY 12	THR LIH green, LIH bi-directional white edge last 600 m yellow, End lights red
TWY	Green CL, blue edge lights and red stop bars

HS1, HS2 - see backside of this page

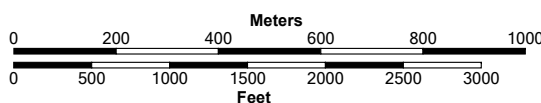

change: Boundary of stands along TWY B1: Position of passenger boarding bridges at Pier A (TERMINAL 1)

RWY 06/24 IN USE

Possible misidentification of TWY D, RWY 12 AND TWY L.
After landing on RWY 06/24 do not vacate via RWY 12 unless explicitly instructed by ATC to do so.

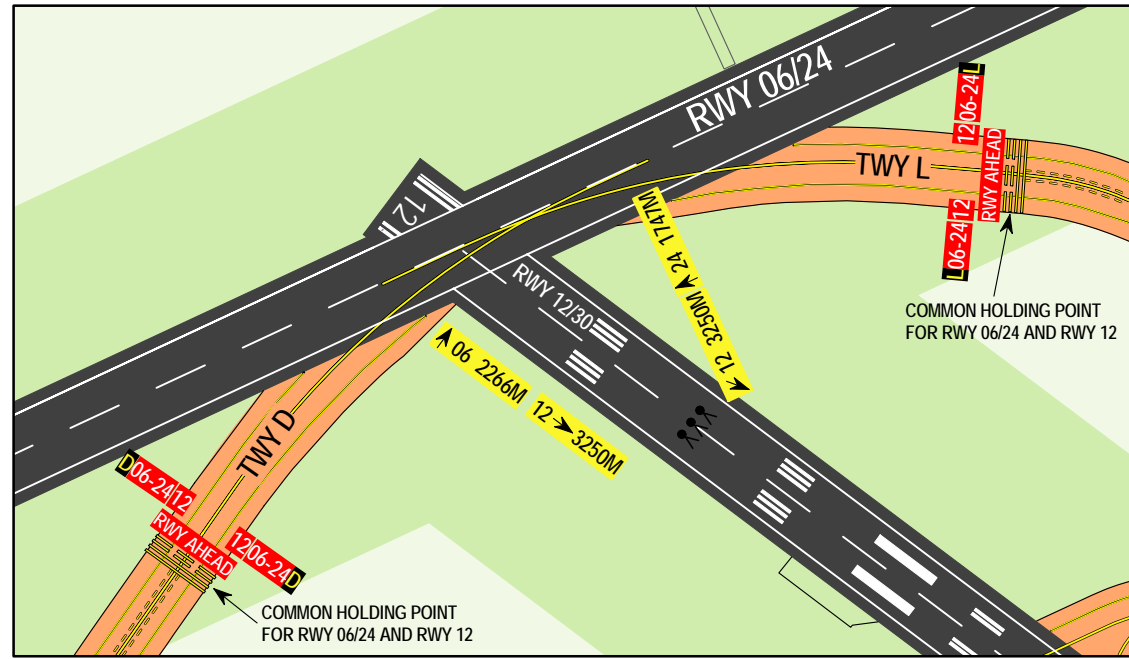

HS1

TWYs D and F cross the active RWY 12/30

The Stop Bars on TWYs D and F are controlled automatically. Pilots must expect a short delay between the clearance to cross the active RWY and the consequent Stop Bar switch-off.

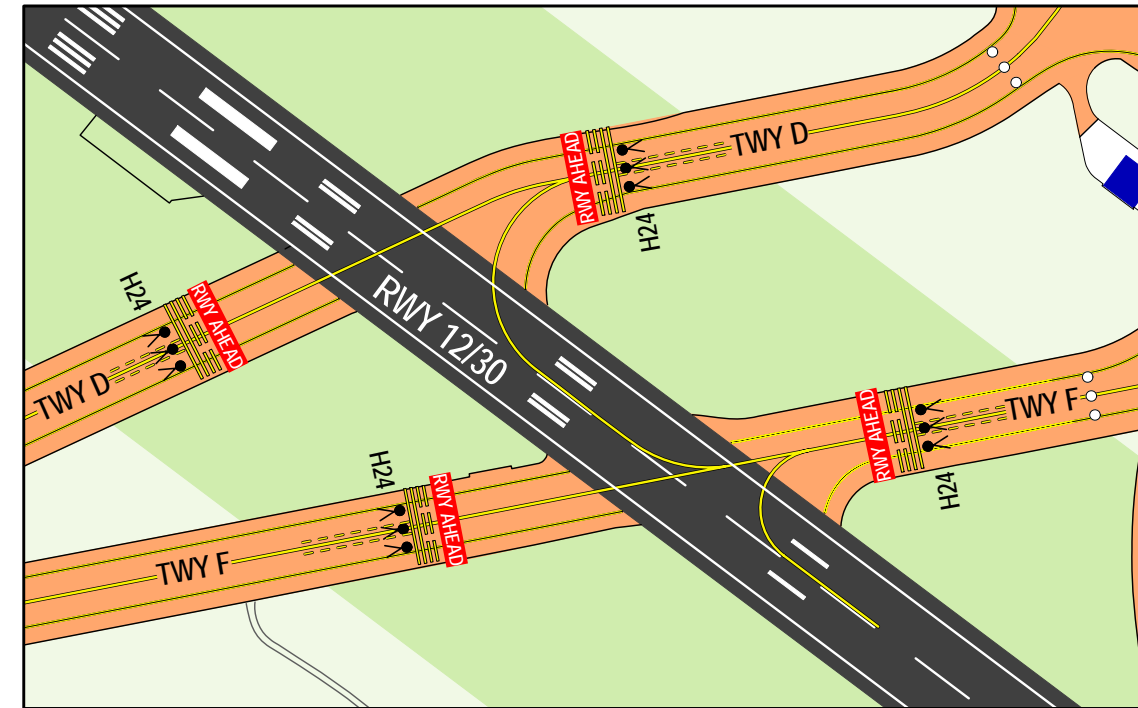

HS2