

# INSTRUMENT APPROACH CHART - ICAO

PRAHA RADAR 127.580  
 RUZYNE RADAR 119.010  
 SUPPLEMENTARY FREQ 136.080  
 RUZYNE TOWER 134.560  
 SUPPLEMENTARY FREQ 118.110  
 EMERGENCY FREQ 121.500

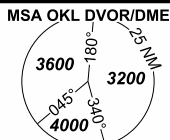

# PRAHA/Ruzyně (LKPR) ILS

**RWY 30**

AERODROME ELEV 1234 ft  
 THR RWY 30 ELEV 1232 ft  
 OCH RELATED TO THR RWY 30

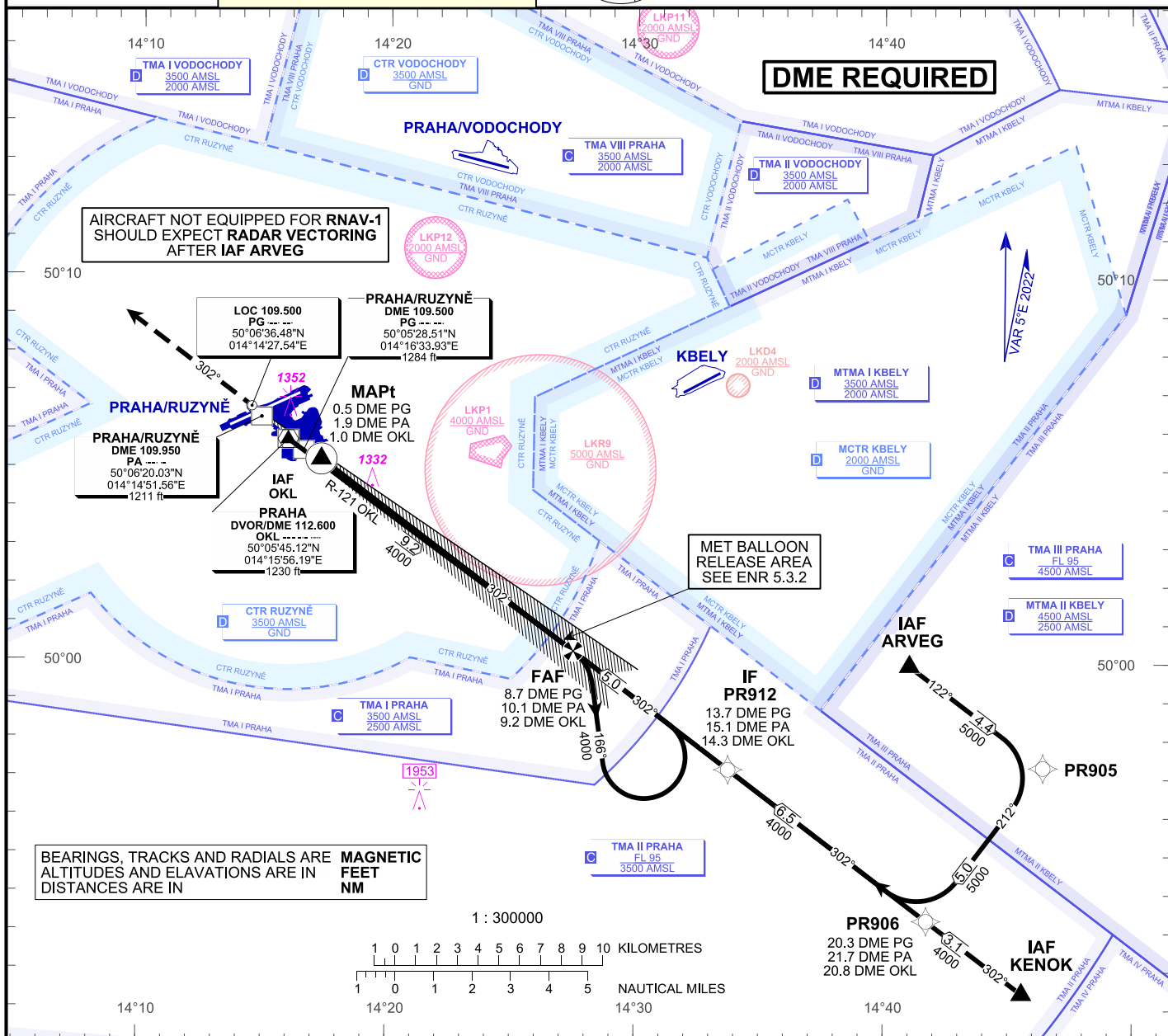

**MISSED APPROACH:**

Climb on track 302° to 4000 ft, radar vectoring will be provided.

In case of RCF climb on track 302° to 4000 ft, at 10 NM DME OKL turn right to OKL and climb to 5000 ft.

THR 50°05'25.68"N 014°16'54.02"E ELEV 1232 ft

DVOR/DME OKL

TRANSITION ALT 5000 ft

LOC DME PA 1610  
 MAPt LOC 0.5 DME PG 1.9 DME PA 1.0 DME OKL  
 FAF 8.7 DME PG 10.1 DME PA 9.2 DME OKL

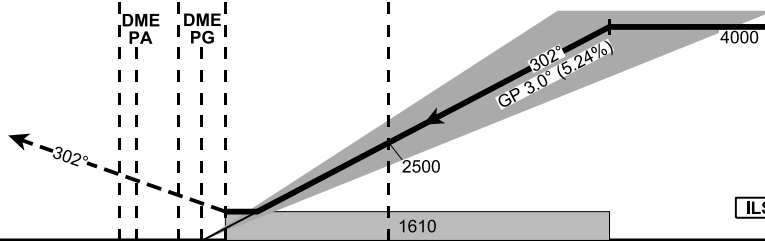

ILS RDH = 59.1 ft

NM FM THR RWY 30

OCA / OCH	A	B	C	D
Straight-in Cat I ft	1372 / 140	1380 / 148	1390 / 158	1401 / 169
Approach LOC ft	1610 / 370			

DME PG	NM	9	8	7	6	5	4	3	2	1
DME PA	NM	10.4	9.4	8.4	7.4	6.4	5.4	4.4	3.4	2.4
DME OKL	NM	9.5	8.5	7.5	6.5	5.5	4.5	3.5	2.5	1.5
DIST THR	NM	8.8	7.8	6.8	5.8	4.8	3.8	2.8	1.8	0.8
ALTITUDES	ft	4090	3780	3460	3140	2820	2500	2180	1860	1540

Change : cancellation of the circling approach

kt	80	100	120	140	160	180	
FAF - MAPt 8.2 NM	min:sec	6:11	4:57	4:07	3:32	3:05	2:45
Rate of descent (5.24%)	ft/min	420	530	640	740	850	960

Timing is not authorised for defining MAPt.