

LKPZ - Pízeň - MAIN

Private domestic heliport HEMS

VFR day/night

49 45 42,68 N, 013 22 44,61 E POS: 1,6 km N Pízeň city center ELEV: 1105 ft / 337 m

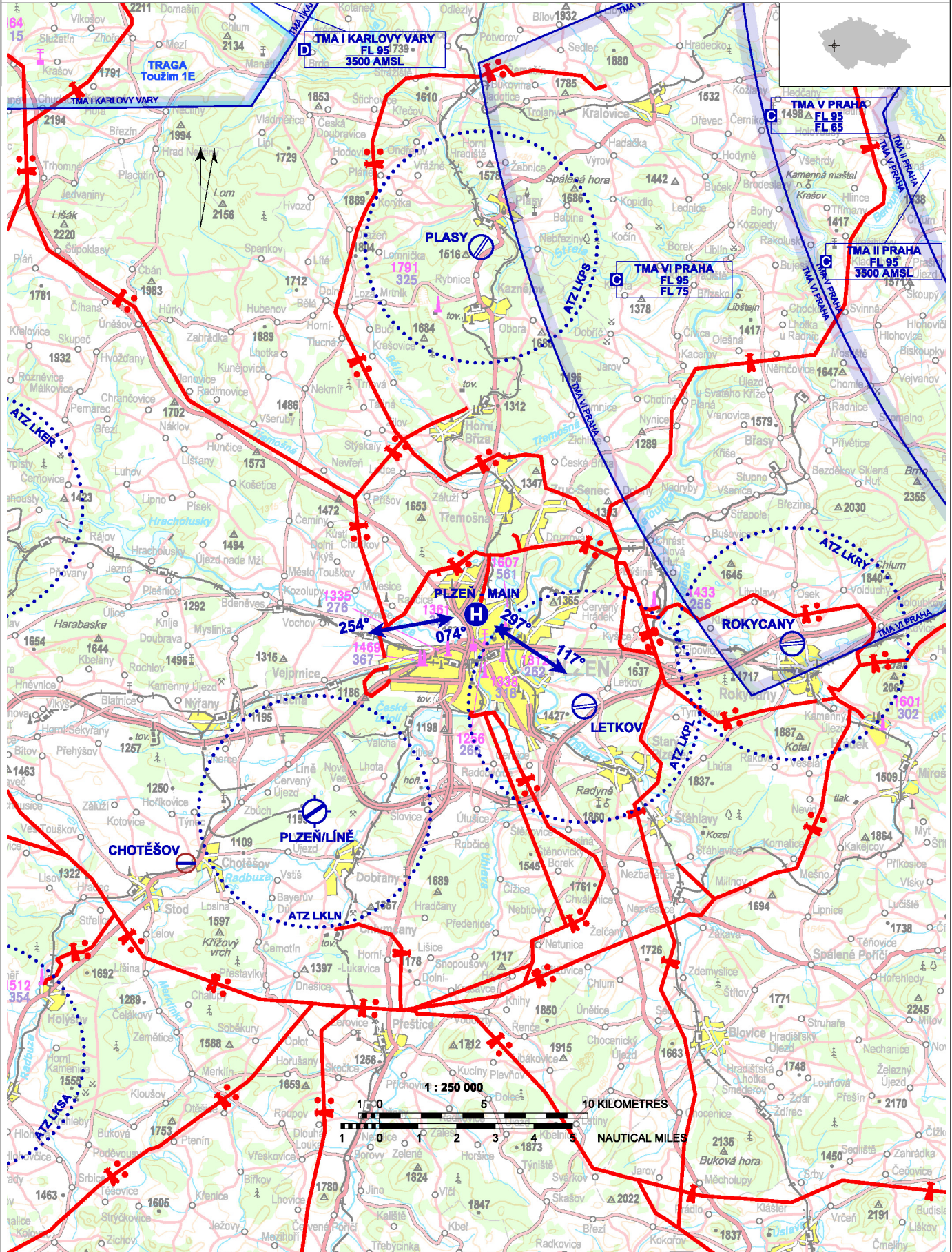

Only HEMS flights allowed.
 Descent gradient 1000 ft/1 NM.
 Lighting system control is provided locally from the control room (phone: +420 377 103 159 or +420 725 986 041).

LKPZ - Plzeň - MAIN

elevated HEMS heliport
 value „D” - 19 m
 FATO – circle diameter 28,3 m, concrete, strength 6400 kg / 0,4 MPa
 SA – circle diameter 37,7 m
 TLOF – circle diameter 28,3 m, concrete, strength 6400 kg / 0,4 MPa

WDI (30 m NNE)
 FATO: designation markings
 TLOF: perimeter markings/lighting TLOF
 A-PAPI: 12°
 ALS: shortened, length 25 m
 heliport beacon

1	Building	49 45 41,50 N 013 22 48,41 E	1133 ft / 346 m	Night marking
2	Building	49 45 42,15 N 013 22 48,46 E	1133 ft / 346 m	Night marking
3	Ventilation	49 45 41,09 N 013 22 48,55 E	1136 ft / 347 m	NIL
4	Building	49 45 42,12 N 013 22 48,42 E	1132 ft / 346 m	NIL
5	Building	49 45 41,52 N 013 22 48,37 E	1132 ft / 345 m	NIL
6	Building	49 45 42,35 N 013 22 47,77 E	1122 ft / 342 m	NIL

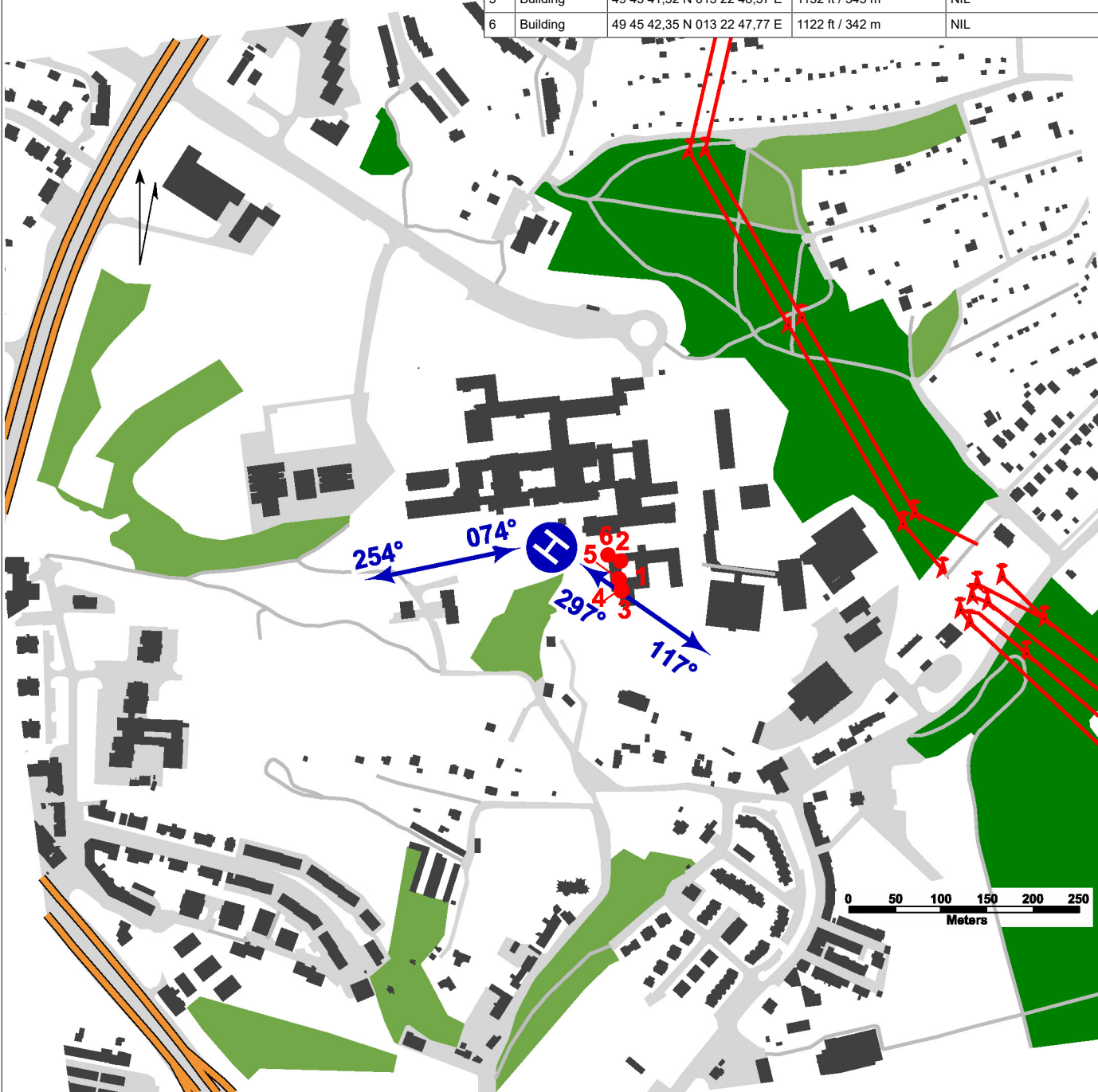

Underlying data © ČÚZK

Fakultní nemocnice Plzeň
 Edvarda Beneše 1128/13, 301 00 Plzeň - Jižní Předměstí

Ondřej Bicek (responsible person of operator)
 ☎ +420 723 187 617, biceko@fnplzen.cz
 PBX ☎ +420 377 103 111
 operational-technical deputy ☎ +420 377 402 500
 dispatching (lighting system control)
 ☎ +420 377 103 159, ☎ +420 725 986 041

	Approach:	Take-offs:
VFR day	297°, 074°	117°, 254°
VFR night	297°	117°, 254°

- HX
- NIL
- NIL
- NIL
- Rescue and fire service: Cat H2