

DESIGNATION	LOCATION	COORDINATES	
ALFA	Sokolnice (railway crossing)	49° 07' 03" N 016° 42' 12" E	Holding
BRAVO	Podolí (highway overpass)	49° 10' 54" N 016° 42' 45" E	Holding
NOVEMBER	Kuřim (railway crossing SE of town)	49° 17' 32" N 016° 33' 37" E	Entry / exit
ROMEO	Rousínov (church)	49° 12' 13" N 016° 53' 10" E	Entry / exit
SIERRA	Klobouky u Brna	48° 59' 52" N 016° 51' 44" E	Entry / exit
VICTOR	Velké Němčice intersection of the highway and minor road NE of the city	48° 59' 47" N 016° 41' 20" E	Entry / exit
WHISKEY	Ořechov (church)	49° 06' 39" N 016° 31' 15" E	Entry / exit

ARRIVAL ROUTES	WAYPOINT SEQUENCE
NOVEMBER 1	NOVEMBER - BRAVO
ROMEO 1	ROMEO - BRAVO
SIERRA 1	SIERRA - ALFA
WHISKEY 1	WHISKEY - ALFA
VICTOR 1	VICTOR - ALFA
DEPARTURE ROUTES	WAYPOINT SEQUENCE
NOVEMBER 1	BRAVO - NOVEMBER
VICTOR 1	BRAVO - VICTOR
SIERRA 1	ALFA - SIERRA
WHISKEY 1	ALFA - WHISKEY
ROMEO 1	ALFA - ROMEO

LKTB BRNO/Tuřany



Tuřany VĚŽ/TOWER
119,605
Tuřany GROUND
125,430

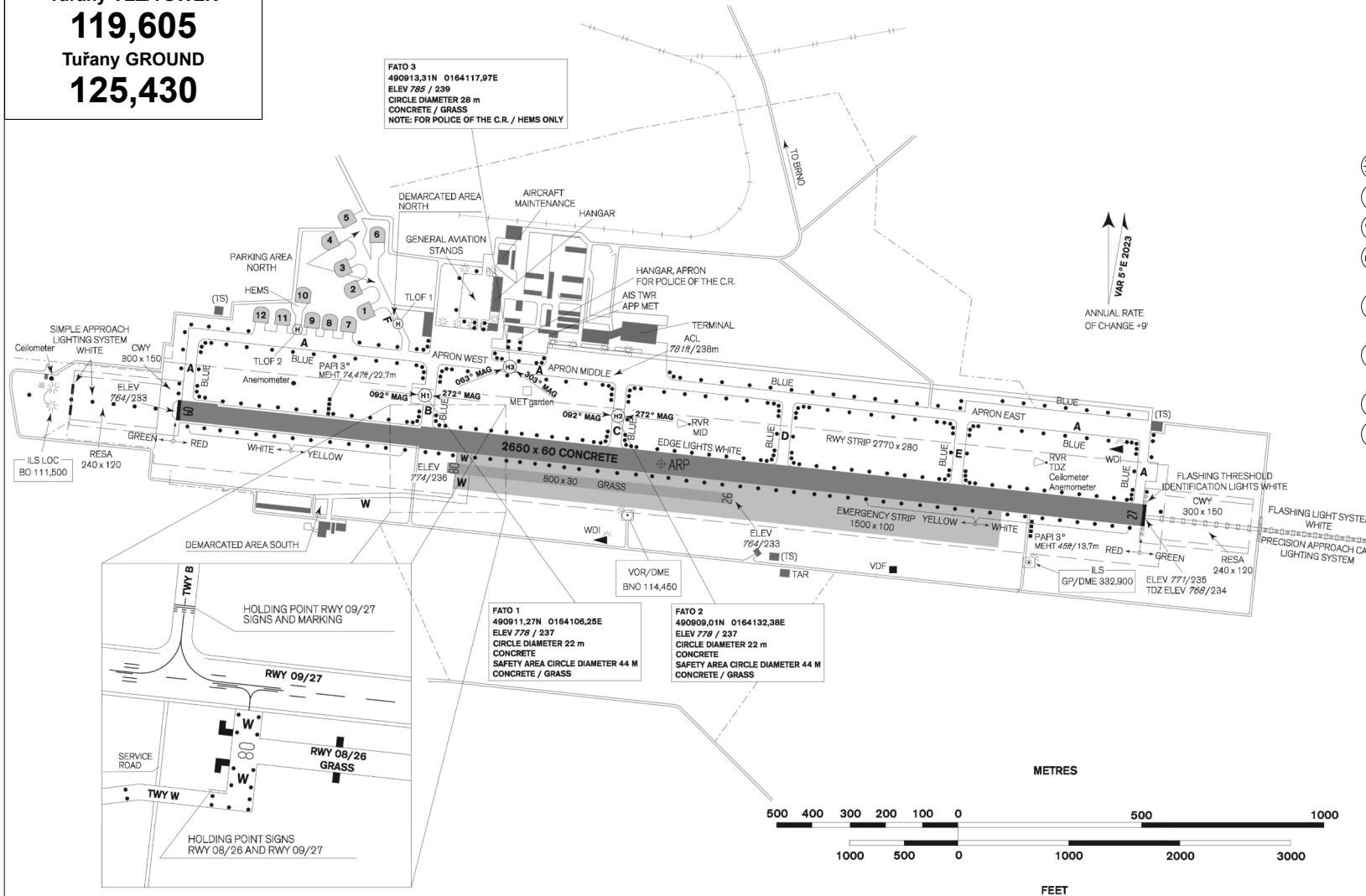

RWY	Magnetic direction	RWY dimensions	Strength	TORA	TODA	ASDA	LDA
09	092°	2650 x 60	PCN 48/R/A/X/T	2650	2950	2650	2650
27	272°	2650 x 60	PCN 48/R/A/X/T	2650	2950	2650	2650
08	092°	800 x 30	5700 kg / 1,5 MPa	800	860	800	800
26	272°	800 x 30	5700 kg / 1,5 MPa	800	860	800	800

LETISTE BRNO a.s.
 Letiště Brno - Tuřany 904/1, 627
 00 Brno, ☎ +420 545 521 111,
 📠 +420 545 216 346,
 AFTN: LKTBYDYX, SITA: BRQCZ7X
 Handling agent at the airport Brno/Tuřany:
 LETIŠTĚ BRNO a.s. (for all
 flights) - ☎ +420 545 521 309,
 📠 +420 545 521 310,
 📠 +420 545 216 346,
 handling@airport-brno.cz,
 AFTN: LKTBYDYX, SITA: BRQCZ7X
 (FREQ: 131,805, call sign BRNO
 HANDLING)

- 🕒 H24
- 🛩️ Jet A1, AVGAS 100 LL
- 🚫 Not available
- 🛩️ Limited for GA aircraft - on request at the aerodrome operator
- 🔧 Contact the airport operator for possibility of aircraft repairs.
- 🏨 Hotels in the city - reservations available through the aerodrome operator.
- 🚶 In the terminal building.
- 🚗 Public transport, taxi, bus (shall be ordered in advance).

Customs and immigration clearance: H24

Taxiing from aprons to RWY 08/26 is led along concrete TWYs, RWY 09/27 and grassy TWYs. RWY 08/26 and grassy TWYs are located in the emergency strip south of RWY 09/27.

Aircraft after landing on the RWY 08/26, unless cleared to taxi, have to vacate RWY to TWY W. TWY W is located south of RWY 08/26. Pilots have to report "RWY vacated" to TWR.

During taxiing to APN from RWY 08/26 the pilots have to ask for clearance to cross RWY 09/27.

During taxiing to RWY 08/26 the pilots have to stop on marked holding positions and ask for a clearance to cross RWY 09/27.

Intentionally left blank